

# KNIFE SWITCHES - DISCONNECTING DEVICES

## M27B

1990



Type:	<b>2 POLES KNIFE SWITCH</b>
Rated voltage:	<b>400 V</b>
Rated current:	<b>16 A (10 A for M27BE)</b>
Resistance to surface currents:	<b>TK 175</b>
Working temperature:	<b>T 120°C</b>
Insulation class:	<b>II</b>
Type of clamps to connect the cables:	<b>SCREW CLAMPS</b>
Clamps connecting capacity:	<b>1,50 ÷ 4,00 mm<sup>2</sup></b>
Overvoltage category:	<b>III</b>
Protection degree (IP):	<b>IP20</b>
In conformity to the standards:	<b>EN 60598-1</b>
In conformity to the requirements of the directive:	<b>2014/35/EU</b>
Approval marks:	<b>CSv - IMQ</b>

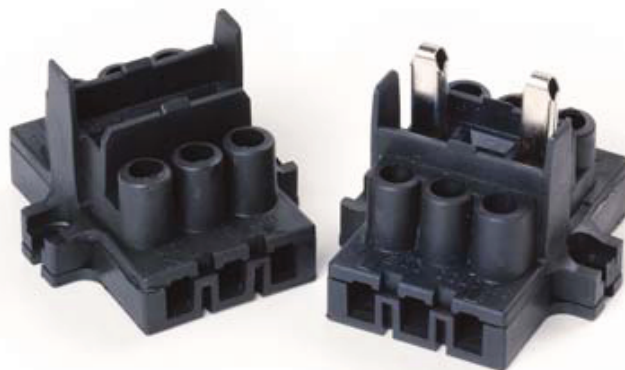

**M27B:** knife switch with rated current 16 A.

**M27BE:** knife switch with rated current 10 A.

**M27B-H:** knife switch as M27B or M27BE with black PPS body and with working temperature T220°C.

- Body in black thermoplastic material PA66 20% G.F. - V0. Contacts in nickel-plated phosphorous bronze. Bush-clamps with screws with combined slot+cross head, for cables section from 1,50 mm<sup>2</sup> to 4,00 mm<sup>2</sup>.

- Weight: 111 g.

*Note: to tighten the clamps screws, use a screwdriver with max. diameter 6 mm.*

- Instructions to fix the knife switch on structures.

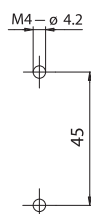

- Fixing of the knife switch using the holes diameter 4,2 mm with center distance 45 mm (if M4 screws are used, the head-diameter should be less than 7,5 mm).

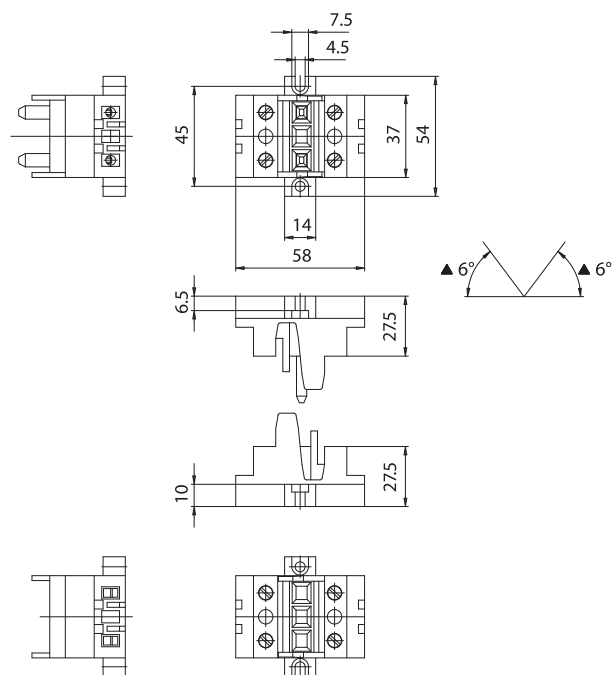

▲ Max. insertion angle

*Attention: the knife switch is provided to be used in internal wiring of lighting fixtures. It is not foreseen that an installer can connect this device to the net.*

