

# KNIFE SWITCHES - DISCONNECTING DEVICES

## M27T

1990



Type:

**2 POLES + GROUND KNIFE SWITCH**

Rated voltage:

**400 V**

Rated current:

**16 A (10 A for M27TE)**

Resistance to surface currents:

**TK 175**

Working temperature:

**T 120°C**

Insulation class:

**I**

Type of clamps to

connect the cables:

**SCREW CLAMPS**

Clamps connecting capacity:

**1,50 ÷ 4,00 mm<sup>2</sup>**

Overvoltage category:

**III**

Protection degree (IP):

**IP20**

In conformity to the standards:

**EN 60598-1**

In conformity to the requirements

of the directive:

**2014/35/EU**

Approval marks:

**CSv - IMQ**

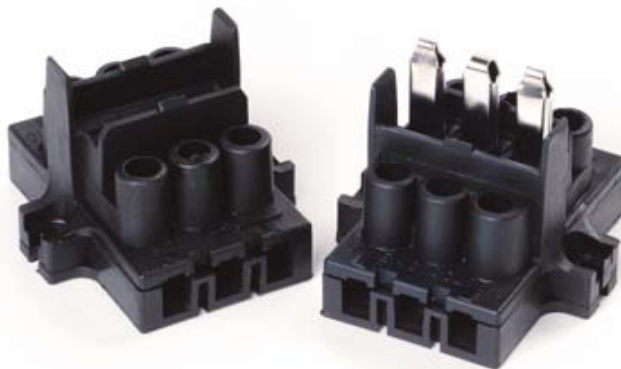

**M27T:** knife switch with rated current 16 A.

**M27TE:** knife switch with rated current 10 A.

**M27T-H:** knife switch as M27T or M27TE with black PPS body and with working temperature T220°C.

- Body in black thermoplastic material PA66 20% G.F. - V0. Contacts in nickel-plated phosphorous bronze. Bush-clamps with screws with combined slot+cross head, for cables section from 1,50 mm<sup>2</sup> to 4,00 mm<sup>2</sup>.

- Weight: 133 g.

*Note: to tighten the clamps screws, use a screwdriver with max. diameter 6 mm.*

- Instructions to fix the knife switch on structures.

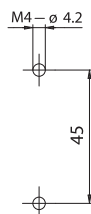

- Fixing of the knife switch using the holes diameter 4,2 mm with center distance 45 mm (if M4 screws are used, the head-diameter should be less than 7,5 mm).

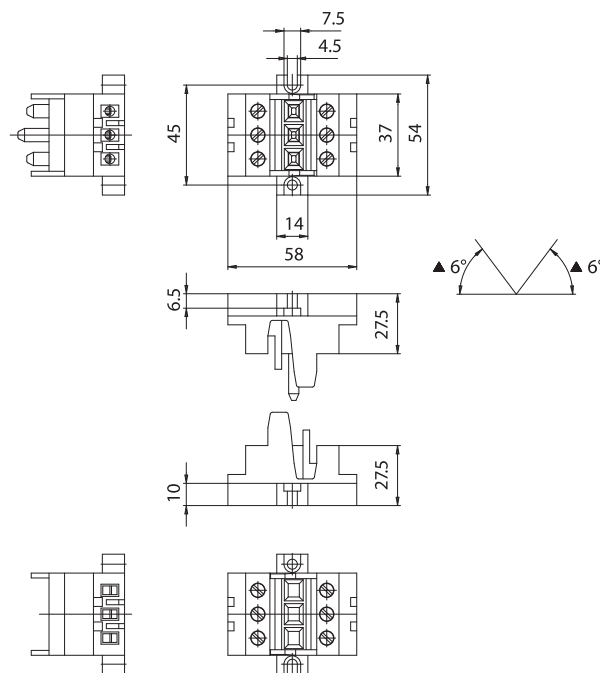

▲ Max. insertion angle

*Attention: the knife switch is provided to be used in internal wiring of lighting fixtures. It is not foreseen that an installer can connect this device to the net.*

