

P113-

P114

P115



Lampholder:

Rated voltage:
Rated current:
Working temperature:
Type of clamps for
cables connection:
Clamps connecting capacity:
Overvoltage category:
Protection degree (IP):
In conformity to the standards:
In conformity to the requirements
of the directive:

E27

**250 V
4 A
T 220°C**

**SCREW CLAMPS
0,75 ÷ 1,00 mm²
III
IP20
EN 60838**

2014/35/EU

Approval marks:

ENEC 10

P113: version with nipple M10 x1
without earth clamp.

P113T: version with nipple M10 x1
with earth clamp.

P114: version with nipple M13 x1
with earth clamp.

P115: version with nipple 3/8"
with earth clamp.

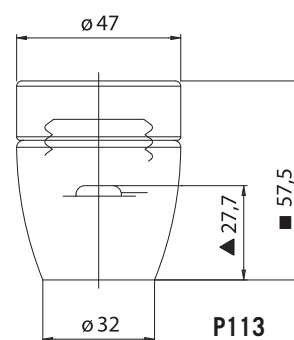
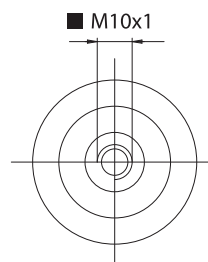

- For P113, nipple M10 x1, height 57,5 mm, and central contact distance 27,7 mm.
- For P113T nipple M10 x1, height 62,5 mm, and central contact distance 32,5 mm.
- For P114 nipple M13 x1, height 62,5 mm, and central contact distance 32,5 mm.
- For P115 nipple 3/8", height 62,5 mm, and central contact distance 32,5 mm.
- ▲ Central contact distance.

